

# OWNER'S MANUAL

ATAC  
DEFENSE  
ENHANCED  
RIFLE

ADER

*This manual should remain  
with the firearm. Transfer is  
recommended upon change of  
ownership.* (c) 2020 ATAC DEFENSE



**ATAC  
DEFENSE**

ATACDEFENSE.COM

QUALITY.DEPENDABILITY.ACCURACY.



## GENERAL WARNINGS

**FIREARM SAFETY IS VERY IMPORTANT**

**FIREARMS ARE DANGEROUS WEAPONS**

**CAREFULLY AND THOROUGHLY READ THE INSTRUCTIONS AND WARNINGS IN THIS MANUAL BEFORE USING.**

ATAC Defense is not responsible for physical injury, death or damage to property resulting from either intentional or accidental discharge of this firearm. ATAC Defense is not responsible for negligence, product malfunctions, criminal use, unauthorized modifications or alteration, or the use of defective, improper or faulty re-manufactured ammunition. We recommend the use of quality commercially manufactured ammunition that matches the caliber of your rifle. ATAC Defense is not be responsible for the damages resulting from use of defective,improper or reloaded ammunition.

### **⚠ WARNING - ALTERATIONS**

This product was designed to function properly in its original condition. Alterations can make it unsafe.

Do not alter any part or add or substitute parts or accessories that are not manufactured by ATAC Defense and designed to be compatible with this firearm.

***DO NOT ALTER ANY FIREARM***

- 2 ... **Table of Contents**
- 3 ... **State By State Warnings**
- 5 ... **Introduction to ATAC Defense**
- 6 ... **Firearm Overview**
- 8 ... **Locking Device Installation Instructions**
- 10 ... **Safety Selector Operation**
- 11 ... **Loading - Magazine**
- 12 ... **Loading - Firearm**
- 13 ... **Firing Your Firearm**
- 14 ... **Firearm Disassembly**
- 16 ... **Firearm Assembly**
- 17 ... **Firearm Lubrication & Cleaning**
- 17 ... **Warranty - Returns - Repairs**

## STATE BY STATE WARNINGS

Certain states require specified firearms warning notices. The notices are required to be in larger than normal type and they must be in a easy to find location. ATAC Defense offers its products in compliance with all applicable laws.

### **⚠ WARNING - CALIFORNIA**

"THIS FIREARM IS NOT COMPLIANT WITH CALIFORNIA STATE LAW"

### **⚠ WARNING - CONNECTICUT**

"UNLAWFUL STORAGE OF A LOADED FIREARM MAY RESULT IN IMPRISONMENT OR FINE"

### **⚠ WARNING - FLORIDA**

"IT IS UNLAWFUL, AND PUNISHABLE BY IMPRISONMENT AND FINE, FOR ANY ADULT TO STORE OR LEAVE A FIREARM IN ANY PLACE WITHIN THE REACH OR EASY ACCESS OF A MINOR UNDER 18 YEARS OF AGE OR TO KNOWINGLY SELL OR OTHERWISE TRANSFER OWNERSHIP OR POSSESSION OF A FIREARM TO A MINOR OR A PERSON OF UNSOUND MIND."

### **⚠ WARNING - MAINE**

"ENDANGERING THE WELFARE OF A CHILD IS A CRIME. IF YOU LEAVE A FIREARM AND AMMUNITION WITHIN EASY ACCESS OF A CHILD, YOU MAY BE SUBJECT TO FINE, IMPRISONMENT OR BOTH. KEEP FIREARMS AND AMMUNITION SEPARATE. KEEP FIREARMS AND AMMUNITION LOCKED UP. USE TRIGGER LOCKS"

### **⚠ WARNING - MARYLAND**

"WARNING: CHILDREN CAN OPERATE FIREARMS WHICH MAY CAUSE DEATH OR SERIOUS INJURY. IT IS A CRIME TO STORE OR LEAVE A LOADED FIREARM IN ANY LOCATION WHERE AN INDIVIDUAL KNEW OR SHOULD HAVE KNOWN THAT AN UNSUPERVISED MINOR WOULD GAIN ACCESS TO THE FIREARM. STORE YOUR FIREARM RESPONSIBLY!"

### **⚠ WARNING - MASSACHUSETTS**

"SALE AND OWNERSHIP OF THIS PRODUCT IS UNLAWFUL"

## STATE BY STATE WARNINGS

Certain states require specified firearms warning notices. The notices are required to be in larger than normal type and they must be in a easy to find location. ATAC Defense offers its products in compliance with all applicable laws.

### **⚠️ WARNING - NEW JERSEY**

"SALE AND OWNERSHIP OF THIS PRODUCT IS UNLAWFUL"

### **⚠️ WARNING - NEW YORK**

"SALE AND OWNERSHIP OF THIS PRODUCT IS UNLAWFUL"

### **⚠️ WARNING - NORTH CAROLINA**

"IT IS UNLAWFUL TO STORE OR LEAVE A FIREARM THAT CAN BE DISCHARGED IN A MANNER THAT A REASONABLE PERSON SHOULD KNOW IS ACCESSIBLE TO A MINOR"

### **⚠️ WARNING - TEXAS**

"IT IS UNLAWFUL TO STORE, TRANSPORT OR ABANDON AN UNSECURED FIREARM IN A PLACE WHERE CHILDREN ARE LIKELY TO BE AND CAN OBTAIN ACCESS TO THE FIREARM."

### **⚠️ WARNING - WISCONSIN**

"IF YOU LEAVE A LOADED FIREARM WITHIN THE REACH OR EASY ACCESS OF A CHILD YOU MAY BE FINED OR IMPRISONED OR BOTH IF THE CHILD IMPROPERLY DISCHARGES, POSSESSES, OR EXHIBITS THE FIREARM."

FEDERAL AND STATE FIREARM LAWS ARE FLUID, CONSTANTLY CHANGING AND EVOLVING. ULTIMATELY, IT IS THE CONSUMERS RESPONSIBILITY TO KNOW THE CITY AND STATE LAWS THAT REGULATE THE OWNERSHIP, POSSESSION AND USE OF A FIREARM.

## INTRODUCTION TO ATAC DEFENSE

ATAC DEFENSE started manufacturing quality parts for other firearm manufactures in 2014.

Every ATAC Defense firearms have been designed to align with our company motto:  
**Quality, Dependability and Accuracy.**

In 2019, we released our first semi-automatic rifle: **ADER (ATAC Defense Enhanced Rifle)**.

**ADER** rifles feature an enhanced trigger, stock, grip and ambi controls. Each rifle is hand-fit and available with a 16" barrel, chambered in either .300 AAC Blackout or 5.56 NATO. The ADER (ATAC Defense Enhanced Rifle) was well received by customers and the firearms industry. Independent reviews of the ADER rifle can be found on-line: Recoil & Gun Digest.

In 2020, we expanded our line up with the release of several new rifles and pistols: ADLRR, ADBR, ADBR PLUS, ADEP and ADBP.

**ADLRR (ATAC Defense Long Range Rifle):** semi-automatic rifle, chambered in .308 with an 18" barrel. The ADLRR was designed with long range accuracy in mind.

**ADBR (ATAC Defense Basic Rifle) and ADBR PLUS:** semi-automatic rifle, 16" barrel, chambered in either 5.56 NATO or .300 AAC Blackout. In-house, the ADBR is known as the "NOT SO BASIC RIFLE. It received this nick-name because we build each rifle using the same quality exacting methodology that we used to build the ADER. All components are hand selected, hand-fit, finished and inspected by our experience firearms experts.

**ADEP (ATAC Defense Enhanced Pistol) and ADBP (ATAC Defense Basic Pistol):** semi-automatic pistol, chambered in either 9mm, 5.56 NATO or .300 AAC Blackout. The 9mm version of the ATAC Pistol is available with either a 4.5" or 8.5" barrel. If you choose the .300 ACC it is available with either a 10.25" or 7.5" barrel. The 5.56 NATO version, is only available with a 10.25" barrel. ADEP enhancements include a PDW pistol brace, drop in 3.5# trigger, ambi controls and an upgraded grip.

ATAC Defense is a family owned business that operates out of Lucedale, Mississippi. Every member of our team is dedicated to excellence and we are unwilling to sacrifice quality for quantity. We are proud of our people and the products that they manufacture.

Thank you for your support and for purchasing one of our firearms.



Chris Johnson - CEO  
ATAC Defense  
Lucedale, MS - USA

## FIREARM OVERVIEW - ADER (ATAC DEFENSE ENHANCED RIFLE)

BRAKE

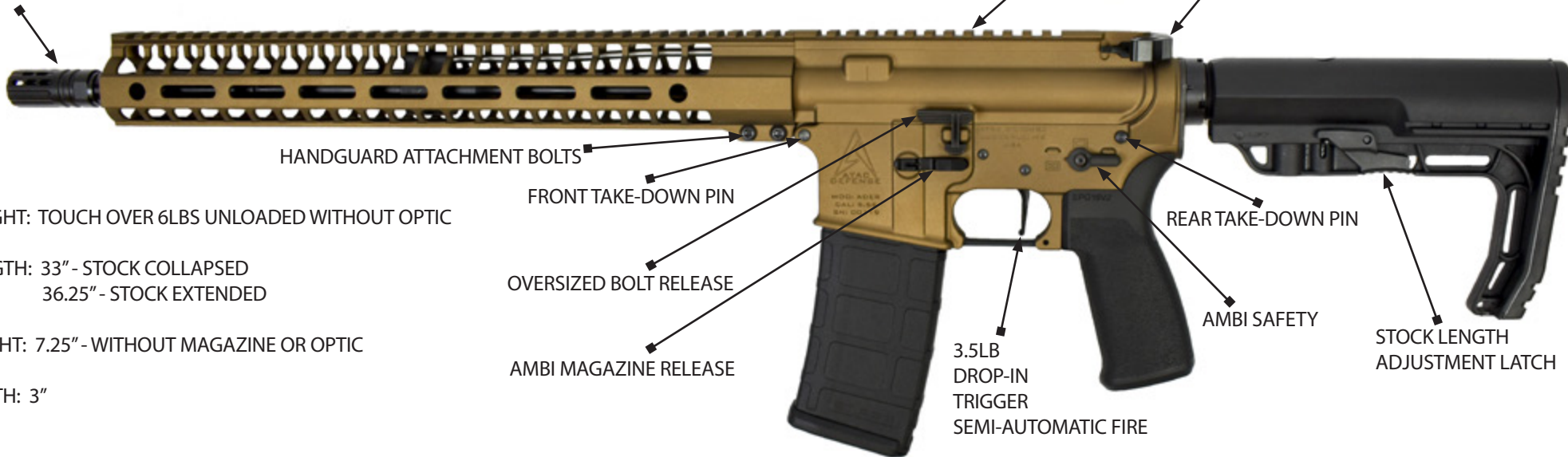

WEIGHT: TOUCH OVER 6LBS UNLOADED WITHOUT OPTIC

LENGTH: 33" - STOCK COLLAPSED  
36.25" - STOCK EXTENDED

HEIGHT: 7.25" - WITHOUT MAGAZINE OR OPTIC

WIDTH: 3"

ADJUSTABLE MINIMALIST STOCK

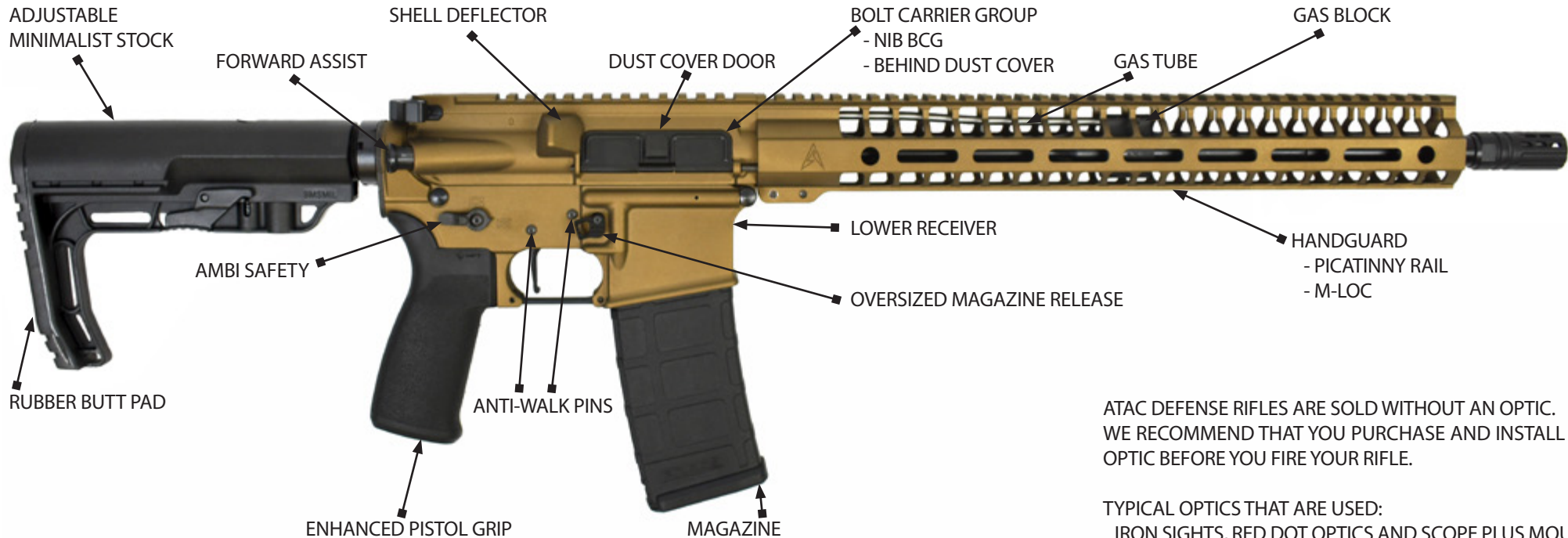

ATAC DEFENSE RIFLES ARE SOLD WITHOUT AN OPTIC. WE RECOMMEND THAT YOU PURCHASE AND INSTALL AN OPTIC BEFORE YOU FIRE YOUR RIFLE.

TYPICAL OPTICS THAT ARE USED:  
IRON SIGHTS, RED DOT OPTICS AND SCOPE PLUS MOUNT



## LOCKING DEVICE INSTRUCTIONS

### STEP 1 - REMOVE THE MAGAZINE

- PRESS THE MAGAZINE RELEASE BUTTON TO REMOVE THE MAGAZINE

### STEP 2 - LOCK THE BOLT BACK

- PULL THE CHARGING HANDLE FULLY TO THE REAR
- PRESS AND HOLD THE BOTTOM SIDE OF THE BOLT RELEASE LEVER
- SLOWLY MOVE THE CHARGING HANDLE FORWARD UNTIL IT CATCHES

### STEP 3 - VERIFY YOUR FIREARM IS UNLOADED

- INSPECT THE CHAMBER AND VERIFY THAT IT IS CLEAR OF AMMUNITION

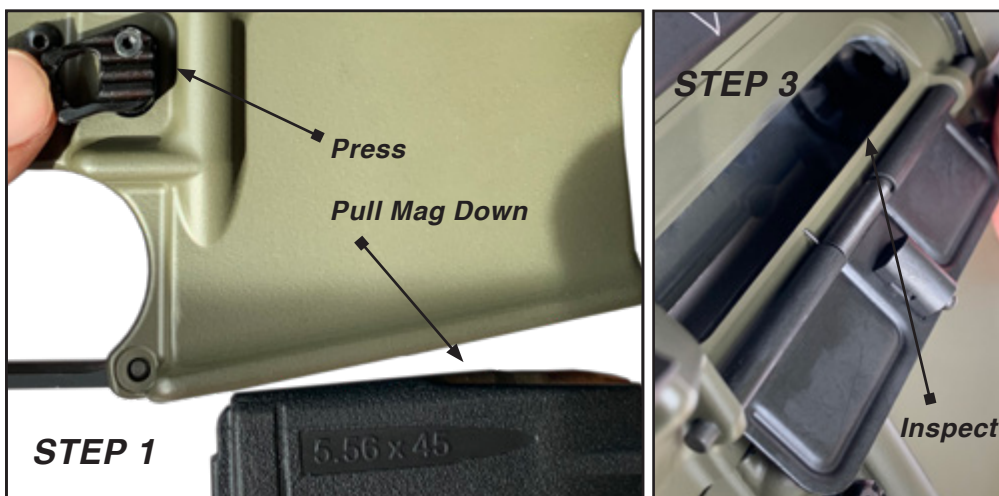

## LOCKING DEVICE INSTRUCTIONS

### STEP 4 - ROTATE THE SAFETY SELECTOR TO "SAFE"

- ROTATE THE SAFETY SELECTOR INTO THE HORIZONTAL - SAFE POSITION

### STEP 5 - ROUTE THE CABLE THROUGH THE MAGWELL

- INSERT THE CABLE INTO MAGWELL AND OUT THROUGH THE EJECTION PORT

### STEP 6 - LOCK THE CABLE

- TURN THE KEY TO THE FULL CLOCKWISE POSITION
- INSERT THE CABLE INTO THE LOCK
- TURN THE KEY TO THE FULL COUNTER-CLOCKWISE POSITION TO LOCK
- VERIFY THE CABLE IS LOCKED BY FIRMLY PULLING ON THE LOCK



## SAFETY SELECTOR OPERATION

### **TWO POSITION AMBI SAFETY** - Fire and Safe

- Safety selector is located on both sides of the firearm (AMBI).
- SAFE = Selector In The Horizontal Position
- FIRE = Selector in the Vertical Position
- The safety selector can not be moved unless the bolt is locked back or the firearm is charged/cocked. NOTE: If the firearm is charged, it can fire.
- To lock the bolt back: Pull the charging handle fully to the rear while pressing and holding the bottom of the bolt release lever, then move the charging handle forward until it catches.

#### **Horizontal Position = SAFE**

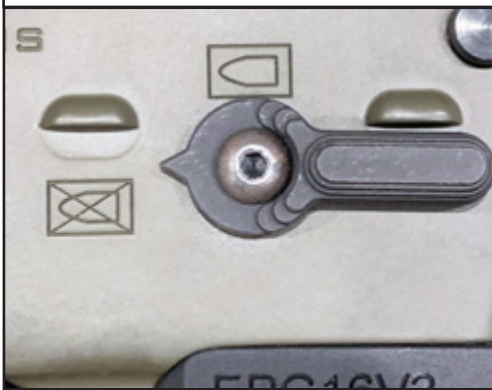

#### **Vertical Position = FIRE**



### **To Operate Safety, Lock the Bolt or Charge the Firearm**



**To Lock the Bolt Back**

## LOADING - MAGAZINE

### **WARNING BEFORE LOADING MAGAZINE**

- ONLY load high quality, commercially manufactured ammunition that is in good condition.
- Be sure to load ammunition of the appropriate caliber.
- Your rifle's caliber is clearly marked on the barrel.
- Rifles chambered in 5.56 NATO are able to fire 223 Remington caliber ammunition and 5.56 NATO ammunition.
- Rifles chambered in 223 Wylde are able to fire 5.56 NATO caliber ammunition and .223 Remington caliber ammunition.
- Rifles chambered in 300 AAC are ONLY ABLE TO FIRE .300 AAC Blackout ammunition.
- DO NOT USE - steel case, imported, hand loaded or re-manufactured ammunition and the use of this ammunition WILL void your warranty.

### **Loading Magazine**

- Use only high quality commercial ammunition that matches your caliber.
- Locate the back of the Magazine.
- Place the back size of a round in between the lips of the magazine with the round projectile pointed to the front of the magazine.
- Push the round down and back into the magazine until it is retained by the magazine lips.
- Place additional rounds on top of the previous round and press down again.
- Repeat until the desired number of rounds are loaded into the magazine.

#### **Back of Magazine**



#### **Push Down and Back**





## LOADING - FIREARM

- STEP 1 - Lock the bolt back.
- STEP 2 - Move the Safety into the SAFE position (Horizontal)
- STEP 3 - Firmly insert a loaded magazine into the firearm.

Note: orientate the magazine so the projectile is facing the barrel.

Push the loaded magazine UP into the magwell until the magazine catch holds the magazine in place.

- STEP 4 - Press the top of the bolt release lever to release the bolt and chamber a round.
- STEP 5 - Push the forward assist to verify that the bolt is locked forward.



## FIRING - FIREARM

- ALWAYS POINT YOUR FIREARM IN A SAFE DIRECTION
- WHEN FIRING - WEAR HEARING AND EYE PROTECTION
- DO NOT CHAMBER A ROUND, UNTIL YOU ARE READY TO FIRE

### FIRING YOUR FIREARM

STEP 1 - Rifle on SAFE, firmly position the BUTT Pad against your shoulder. (RIGHT Shoulder - Right Handed...LEFT Shoulder - Left Handed)

STEP 2 - Align the Optic or Sights to the target.

STEP 3 - FINGER OFF THE TRIGGER - SAFETY OFF

STEP 4 - SMOOTHLY PULL THE TRIGGER - The rifle will fire. Each time it fires, the round is ejected and a new round is loaded (until the magazine is empty). NOTE: After the last round is fired from the magazine, the bolt will remain locked back.

STEP 5 - A) Press the Magazine Release to remove the empty magazine. B) INSERT a loaded magazine and C) press the release bolt to chamber a new round. D) Push the forward assist to verify that the bolt is locked forward.

STEP 6 - When finished firing, always engage the SAFETY ON

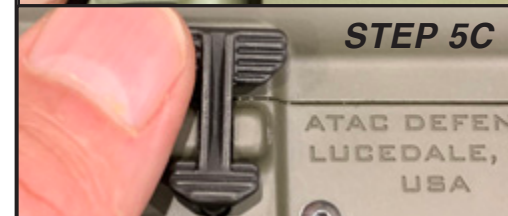
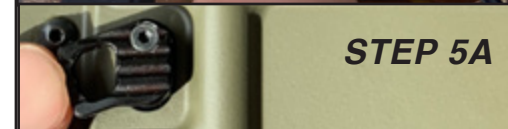



## FIREARM DISASSEMBLY

- STEP 1 - VERIFY the firearm is unloaded and the BOLT is forward.
- NOTE: If the bolt is not forward, the upper and lower will not separate.
- STEP 2 - PUSH the rear takedown pin out of the upper receiver.
- STEP 3 - Carefully separate the UPPER and LOWER. ROTATE the UPPER Assy UP and PUSH the front pivot pin out of the upper receiver.

**NOTE: Rear takedown and front pivot pins will remain in the lower.**  
**Use a non-marring tool to push the pins and buffer plunger.**

- STEP 4 - Remove the BOLT Carrier Group & CHARGING Handle. Hold the Upper UPSIDE DOWN. Slowly pull the charging handle back out.
- STEP 5 - Remove the BUFFER & SPRING. Use your thumb to hold the BUFFER away from the plunger, depress plunger with a **non-marring tool**.

**NOTE: STEPS 6-10 cover BCG Disassembly and are OPTIONAL.**

- STEP 6 - Remove the Firing Pin Retaining Pin from the Bolt Carrier.
- STEP 7 - Remove the Firing Pin from the Bolt Carrier.
- STEP 8 - Push the Bolt to the CLOSED position (Push into the carrier).
- STEP 9 - Rotate the CAM PIN 1/4 Turn and Remove from Bolt Carrier.
- NOTE: Rotate the Bolt slightly so the CAM PIN can clear the GAS KEY.
- STEP 10 - Remove the BOLT from the Bolt Carrier.
- STEP 11 - Clean and Reassemble Firearm

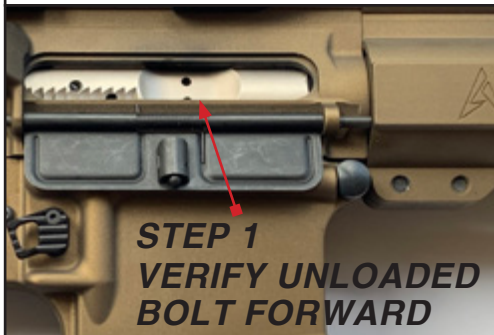

## FIREARM DISASSEMBLY

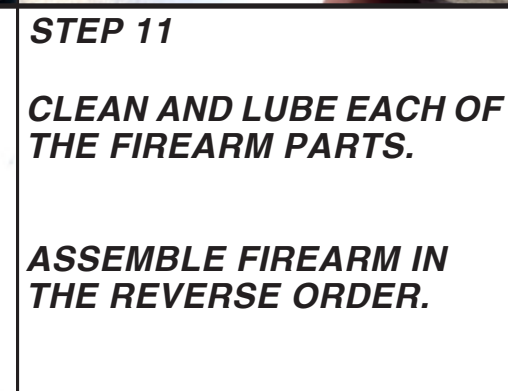
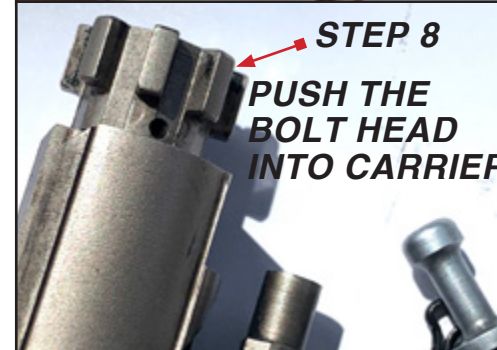
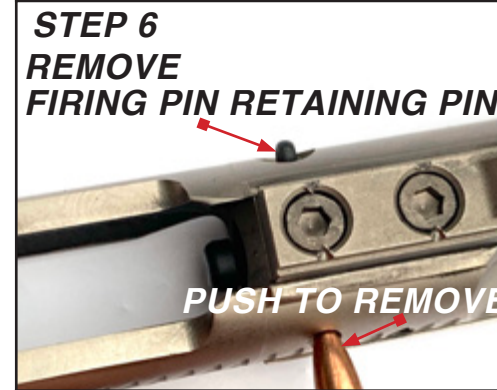



## FIREARM ASSEMBLY

- STEP 1 - VERIFY the firearm is CLEAN. Reverse the order of disassembly.
- STEP 2 - INSTALL the BOLT into the Bolt Carrier.
- STEP 3 - INSTALL the CAM PIN into the BOLT and Bolt Carrier. Once installed, turn 1/4 Turn to lock in place. NOTES: You might have to rotate the Bolt slightly so the CAM PIN can clear the GAS KEY. The CAM PIN only fits into the BOLT FROM one direction. If your CAM PIN will not slide into the bolt, verify that the bolt is clocked correctly.
- STEP 4 - INSTALL the Firing Pin into the Bolt Carrier and Bolt. NOTE: Rotating the BOLT slightly can help with installing the firing pin.
- STEP 5 - Pull the Bolt FACE OUT and INSTALL the Firing Pin Retaining Pin through the BOLT Carrier past the Firing Pin out through the opposite side of the Bolt Carrier. NOTES: Installing the Firing Pin Retaining Pin can be a bit tricky. Install the Firing Retaining Pin as shown below, push down, while pushing it into the Bolt Carrier Group. Be sure to push down on the head, while you gently rotate the Retaining Pin back and push the pin into place. (See Step 5 picture below. Line up as shown, push down and in)
- STEP 6 - Hold the Upper UPSIDE DOWN. Insert the charging handle part way into the upper. NOTE: The charging handle has tabs that fit into the upper. Carefully insert the BOLT Carrier Group into the upper and push the CHARGING Handle forward. (See Step 6 picture below)
- STEP 7 - Carefully attach the UPPER to the LOWER via the FRONT PIN, PUSH the front take-down pin into the upper receiver. Carefully lower the UPPER to the LOWER receiver.
- STEP 8 - Hold the Upper and Lower Together and PUSH the rear take-down pin into the upper receiver.

**Pictures similar to disassembly (extra detail steps 5/6).**

### STEP 5 INSTALL FIRING PIN RETAINING PIN

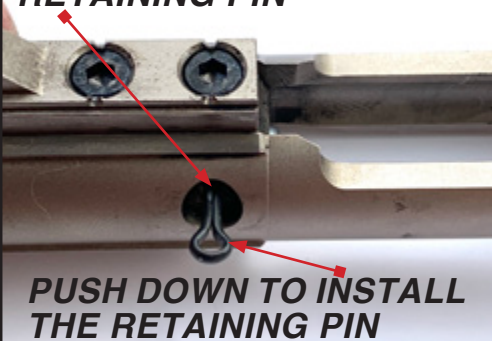

### STEP 6 INSTALL CHARGE HANDLE

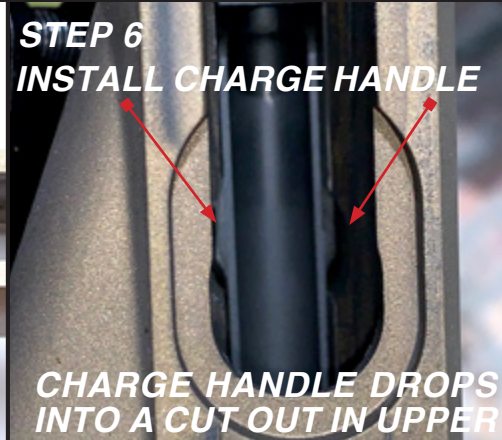

## FIREARM LUBRICATION & CLEANING

- Clean the barrel, bolt carrier group, upper, charging handle and buffer assy.
- Lubricate the firearm after cleaning and before assembly.
- We recommend using a commercial brand of firearm lubrication.  
ATAC Defense Firearms Lubricant is available on our website.
- The parts below have been fired for 3500 rounds, have been cleaned and are ready to be reassembled.



## WARRANTY - RETURNS - REPAIRS

### LIFETIME WARRANTY:

Firearms and parts manufactured by ATAC Defense are backed by our Full Lifetime Warranty and are warranted to be free from defects in materials and craftsmanship. Liability under this warranty shall be limited to the obligation to repair the defect or replace the firearm/part at our discretion. Unauthorized modification of the firearm or part will void this warranty. The lifetime warranty does not cover ordinary wear and tear or any damage resulting from careless handling, neglect, repairs or adjustments, improper, substandard, reloaded or defective ammunition, corrosion, or other unreasonable use of the firearm or part. ATAC Defense shall not be responsible for incidental or consequential damages with respect to economic loss or injury to property, whether as a result of express or implied warranty, negligence or otherwise. Some states do not allow the exclusion or limitation of incidental or consequential damages, so the above limitation may not apply to you.

### RETURNS POLICY:

You may return new, unopened items within 30 days of delivery for a full refund. We DO NOT ACCEPT USED PRODUCT returns.

### REPAIRS:

Three Steps for sending in a firearm for repair: 1) Call for a firearm RA number. 2) Pack the unloaded gun(s) in a case or box and secure it inside another shipping package. The original ATAC case is preferred. Remove ALL other items from the case including magazines (DO NOT SEND MAGAZINES OR ANY ACCESSORIES). 3) Print out your shipping label and attach it to the package. Please be sure that all label information prints out on the paper clearly, and take the package to a main UPS or FedEx shipping hub/terminal. Many retail locations such as Kinko's or UPS stores will not ship firearms.



**ATAC DEFENSE**



**QUALITY. DEPENDABILITY. ACCURACY.**

Manufactured in Lucedale, MS. Visit us at [www.ATACdefense.com](http://www.ATACdefense.com)